

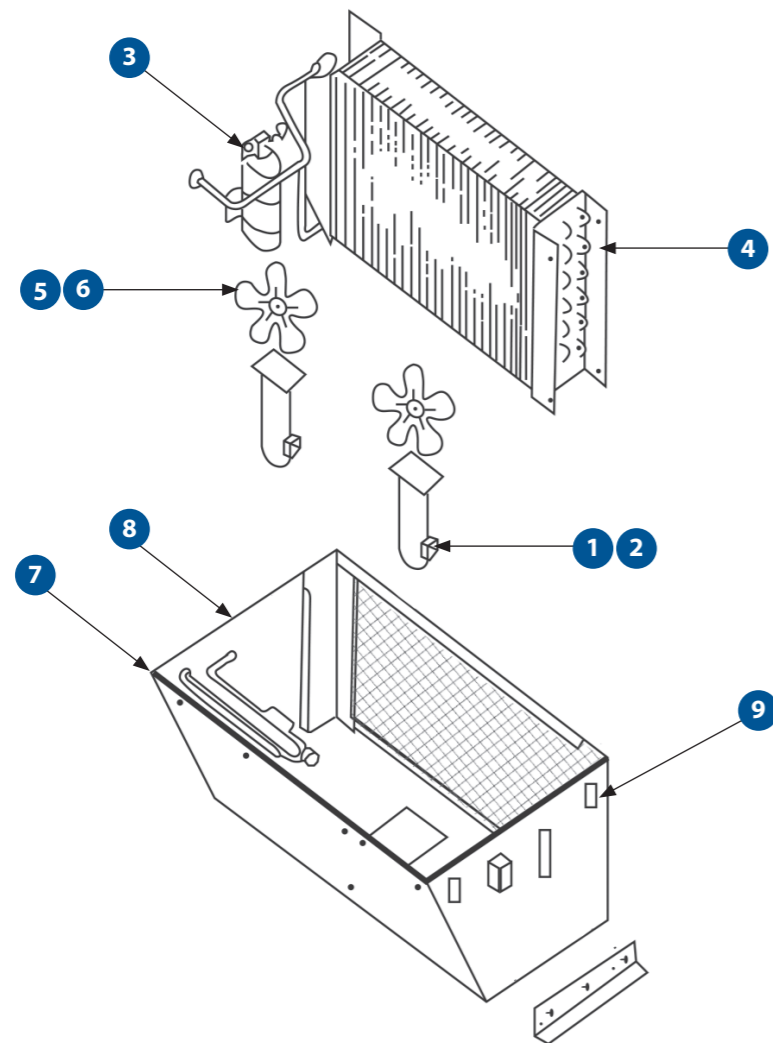

## EB9C CONDENSER

EB9C2X\* | EB9C4X\*

\* HVAC obsolete, spares support only



## SPARE PARTS

PART NO.	DESCRIPTION	QTY
1	AU320028 MOTOR BRUSH KIT - ASSEMBLY + HOLDER	2
2	AU320027 MOTOR 12V (EB9C2) AU320133 MOTOR 24V (EB9C4)	1
3	AU531411 RECEIVER DRIER 3/8" 24UNF165MM HIGH	1
4	UR039 CONDENSER COIL	1
5	AU420020 FAN AXIAL 203MM CW 5 BLADES	2
6	UC306 SHAFT EXTENSION 3/8" F X 5/16" M	2
7	UR009 BULKHEAD FITTING 3/8" MF #6	1
8	UR008 BULKHEAD FITTING 1/2" MF #8	1
9	UC048 LATCH TOGGLE OVER-CENTRE	2
	UE700 CIRCUIT BREAKER 40A STUD TYP MANUAL	1
	UC318 MOTOR MOUNT T SERIES ALUMINIUM	2
	UC047 KEEPER PLATE ZP	2
	AU553650 CLAMP	2
	BC094S CONDENSER LID	1
	UE064 DPC 1/4" MF HP 2206kPa LP 196kPa	1

## SPECIFICATIONS

	METRIC	IMPERIAL
<b>Cooling Capacity</b>	5.0 kW	17060 BTU
<b>Heating Capacity</b>	4.6 kW	15695 BTU
<b>Power Supply</b>	24V / 12V	24V / 12V
<b>Current Draw</b>	10A / 20A	10A / 20A
<b>Refrigerant</b>	R134a	R134a
<b>Maximum Ambient Temperature</b>	46°C	115°F
<b>Weight (nominal)</b>	29.0 Kg	63.8 lbs
<b>Technical Manual Reference</b>	SM144-2071	SM144-2071
<b>Dimension L X W X H</b>	875mm X 810mm X 320mm	34.4in X 31.9in X 12.6in

## MAINTENANCE

### 6 MONTHS / 1,800 HOURS

**AU320028** MOTOR BRUSH KIT - ASSEMBLY + HOLDER

### ANNUAL / 3,600 HOURS

**AU320027** MOTOR 12V (EB9C2)

**AU320133** MOTOR 24V (EB9C4)

**AU531411** RECEIVER DRIER 3/8" 24UNF165MM HIGH

Please contact SIGMA for more information including details on an overhaul scope and interval. Maintenance periods and scope are dependent on application and site conditions, and are to be used as a guide.

## COMPANION ITEMS

PART NO.	DESCRIPTION
<b>EB9EH4</b>	Evaporator
<b>EB9P4X</b>	Pressuriser
<b>HDC150</b>	Hydraulic Compressor
<b>AU2961001</b>	Electric Compressor
<b>AU270306</b>	Engine Driven Compressor
<b>AU270307</b>	Engine Driven Compressor