

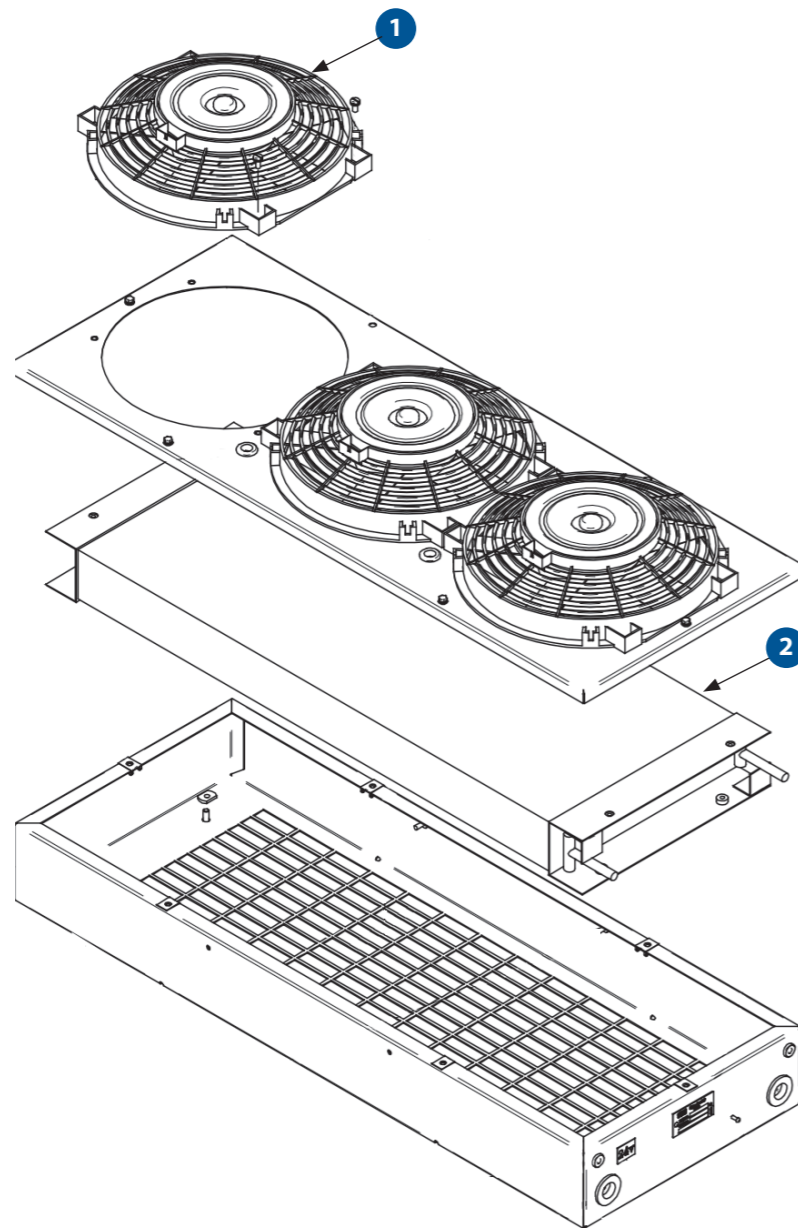

EC22C

REMOTE CONDENSER

EC22C2 | EC22C4 | EC22C4SS



SPARE PARTS

PART NO.	DESCRIPTION	QTY
1 AU420050	FAN AXIAL ASSEMBLY 260MM 12VDC (EC22C2)	3
AU420051	FAN AXIAL ASSEMBLY 260MM 24VDC (EC22C4)	3
2 AU110389	CONDENSER (EC22C4SS)	1
AU110388	CONDENSER (EC22C2 EC22C4)	1

SPECIFICATIONS

	METRIC	IMPERIAL
Cooling Capacity	6.0 kW	20472 BTU
Fan Speeds	1	1
Power Supply	24V / 12V	24V / 12V
Current Draw	10 A / 20 A	10 A / 20 A
Refrigerant	R134a	R134a
Maximum Ambient Temperature	46°C	115°F
Weight (nominal)	14.0 Kg	30.8lbs
Technical Manual Reference	SM260-2494	SM260-2494
Dimension L X W X H	908mm X 332mm X 190mm	35.7in X 13.1in X 7.5in

MAINTENANCE

ANNUAL / 3,600 HOURS

AU420050	FAN AXIAL ASSEMBLY 260MM 12VDC
AU420051	FAN AXIAL ASSEMBLY 260MM 24VDC

Please contact SIGMA for more information including details on an overhaul scope and interval. Maintenance periods and scope are dependent on application and site conditions, and are to be used as a guide.

COMPANION ITEMS

PART NO.	DESCRIPTION
EC22H4	Hoodliner Evaporator
EB9P4X	Pressuriser
HDC150	Hydraulic Compressor
AU2961001	Electric Compressor
AU270306	Engine Driven Compressor
AU270307	Engine Driven Compressor
AU2790311	Engine Driven Compressor
AU270312	Engine Driven Compressor
AU531422	Receiver Drier

- DRAGLINE & SHOVEL
- DRILL
- EXCAVATOR
- DOZER
- TRUCK
- WHEEL LOADER
- CONSTRUCTION
- UNDERGROUND EQUIPMENT
- INDUSTRIAL
- SMELTERS
- RAIL SPECIAL VEHICLES